

The WiNSpace News

Issue 20 - Oct 2023

Go to the: [WiNSpace Website](https://winspace.org.uk) [click here](https://winspace.org.uk)



WiNSpace FUNDRAISING LAUNCHED

**The Winscombe Community Association are at work to
'Make it Happen'**

The Village Show - 9th September

In the last Newsletter we announced the WiNSpace Fundraising Campaign would be launched at the Village Show on the 9th September. This was a very successful event: over 700 people attended with the Fund Raising Team raising £3,500 during the day - a fantastic sum! Much of this money will be going to the WinSpace project - more steps closer to our target. The Fundraising team have also held a recycling event and book sale in the last month raising a further £1000, with the Christmas Fair still to come in 2023.

We thank all our volunteers and helpers who made these days/events such a great success.

Donations - time to back the Project - time to spread the word - please act now

£4,500 is a great start but we now need the village to back the project with donations, and to spread the word. No amount is too small or too large! Our thanks go to all those who have already donated.

How to give: -

- ✓ Visit <https://winspace.org.uk/support/>
- ✓ Use the card-reader Donation Station in the Community Centre outside the kitchen,
- ✓ Why not Buy A Foot! - A square foot in the new building
- ✓ Or contact one of the team at support@winspace.org.uk

Winspace Progress update:

The WinSpace Project is now working towards a start date for Phase 1 in Summer 2024 with lots of activity in progress alongside the fundraising campaign.

We will be having a **Question & Answer Stand** at the popular **Thursday and Saturday Markets on the 16th and 18th November**. So please come and talk to us and hear firsthand the plans and what is going to happen. Recent activities include:

- (i) **Grants:** There was a positive site visit from the National Lottery last week, fingers crossed we make it to the next stage; other grants under application include one from the Community Ownership Fund. We'll get more information by early 2024 how these applications are progressing but it's a slow process.
- (ii) **We've appointed** a Quantity Surveyor who will also act as the construction project manager. We have also taken on an experienced 'project consultant' to advise the Project and Trustees. The next step is to write a detailed specification of the new building which we will be sent out to Construction companies around the New Year for tender! Our Detailed design is now on the way, with more information on page 2.
- (iii) **Headmasters House:** The necessary agreements required are being progressed with the Parish Council and North Somerset Council for us to sell the Headmasters House.
- (iv) **Understanding Build Logistics:** We're now looking at how the WCA can fully accommodate all users during the building process. There will be more information on this shortly once we have developed more details

WiN scombe
newSPACE

Issued by the WiNSpace committee and WCA Trustees

To get in contact just send an email to Info@winspace.org.uk

a modern venue for the village

The WiNSpace News

Issue 20 - Oct 2023

Go to the: [WiNSpace Website](https://www.winspace.org.uk) [click here](https://www.winspace.org.uk)



These are the latest designs for the New building (Phase 1) and Old School Refurbishment (Phase 2)

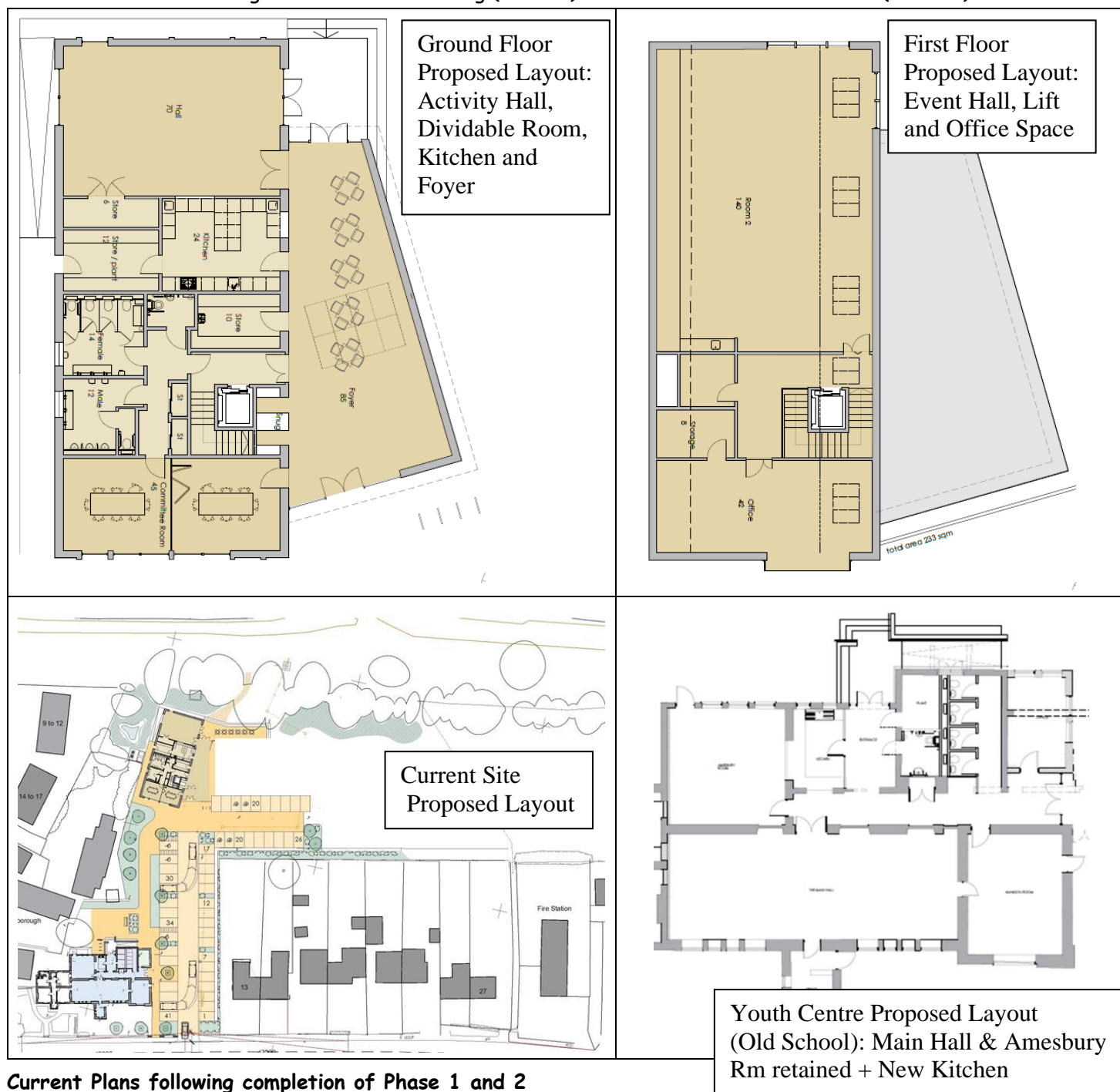

Current Plans following completion of Phase 1 and 2

Although we have a long way to go to finalise the designs and site plans, here are our current thoughts for Phase 1 and 2. These include fantastic open communal spaces, including picnic areas adjacent to the Millennium Green, a large pedestrian path between the two buildings, great for outdoor markets, improved frontage area between the new Youth Centre and the Sandford Road, plus retention of most of the field green space. We hope to have a wildlife / flower meadow to encourage the birds, bats and bees to enjoy the space as much as us.

During the build of the New Building we are planning to keep the Main Building and the Annexe fully functional.

**Please be part of saving and creating a Community Centre
for generations to come.**

Issued by the WiNSpace committee and WCA Trustees

To get in contact just send an email to Info@winspace.org.uk

WiNscombe
newSPACE
a modern venue for the village